

**Series PGH**

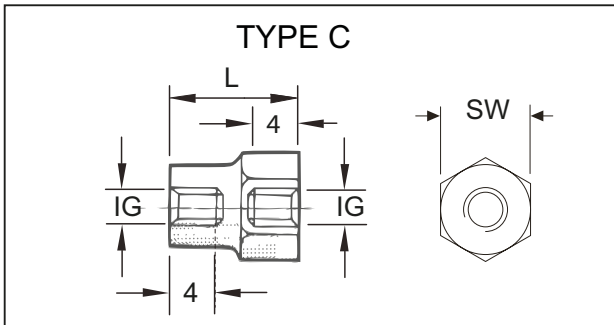
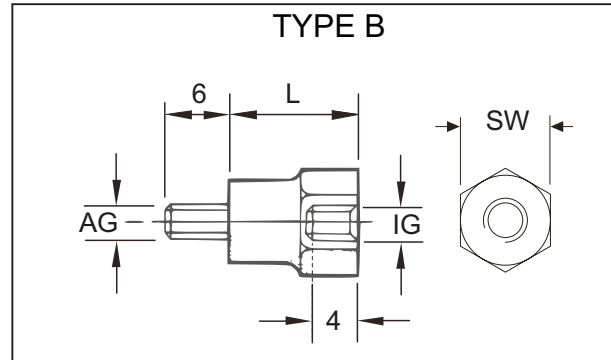
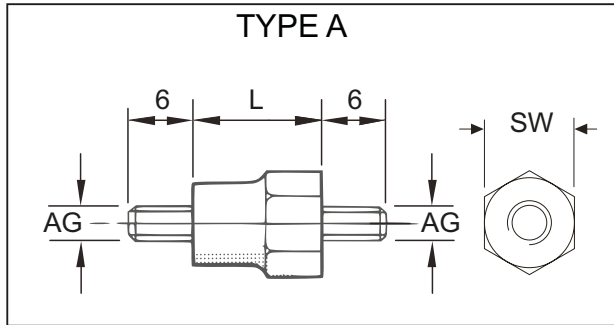

AG / IG	SW
M2,5	6 mm
M3	7 mm

Example of order code			
Article	Thread	Length	Type
PEG H-M2,5-3-A	M2,5	3	A
PEG H-M3-10-A	M3	10	A
PEG H-M3-12-C	M3	12	C

Dimensions in mm

L
4 mm (only type A)
5 mm (only type A)
6 mm (only type A)
7 mm (only type A and B)
8 mm (only type A and B)
9 mm (all types)
10 mm (all types)
11 mm (all types)
12 mm (all types)